

SAN LEANDRO DUPLEX WITH LOTS OF POTENTIAL

Asking Price: \$625,000

2326-2328 Cherry Street, San Leandro, CA 94577



This San Leandro Duplex is located on a large and deep lot on Cherry Street, off Marina Boulevard. The lot is approximately 146' deep, and has an approximately 40' street frontage on Cherry Street in the front and another approximately 40' street frontage on Loquat Lane in the rear. 2326-2328 Cherry Street has lots of potential and features almost identical 2-story, 2-bedroom, 1-bathroom units. Each unit has its own gas, electric and water meter, and laundry facilities. 2-car garage. Close proximity to San Leandro BART Station, AC Transit busline, San Leandro Hospital, schools, and local amenities on E 14th Street.

1,760 Sq.Ft. Living Area.

5,840 Sq.Ft. Lot Size.

Circa 1952.

[Floor Plan on the reverse side](#)
www.Panavista.com/2326Cherry

Broker: Ramesh
Ramesh@Panavista.com



(510) 523-0707
PANAVISTA REALTY
2503 Lincoln Avenue, Alameda

FLOOR PLAN FOR 2326-2328 CHERRY STREET, SAN LEANDRO

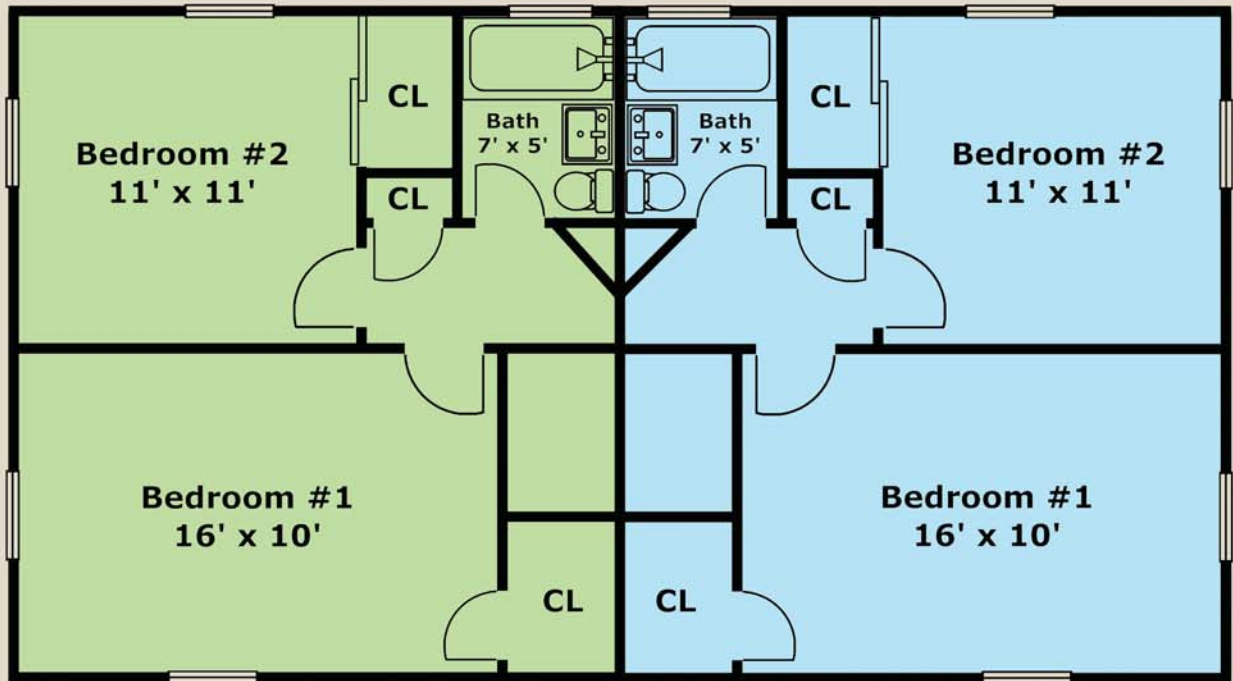

UPPER LEVEL

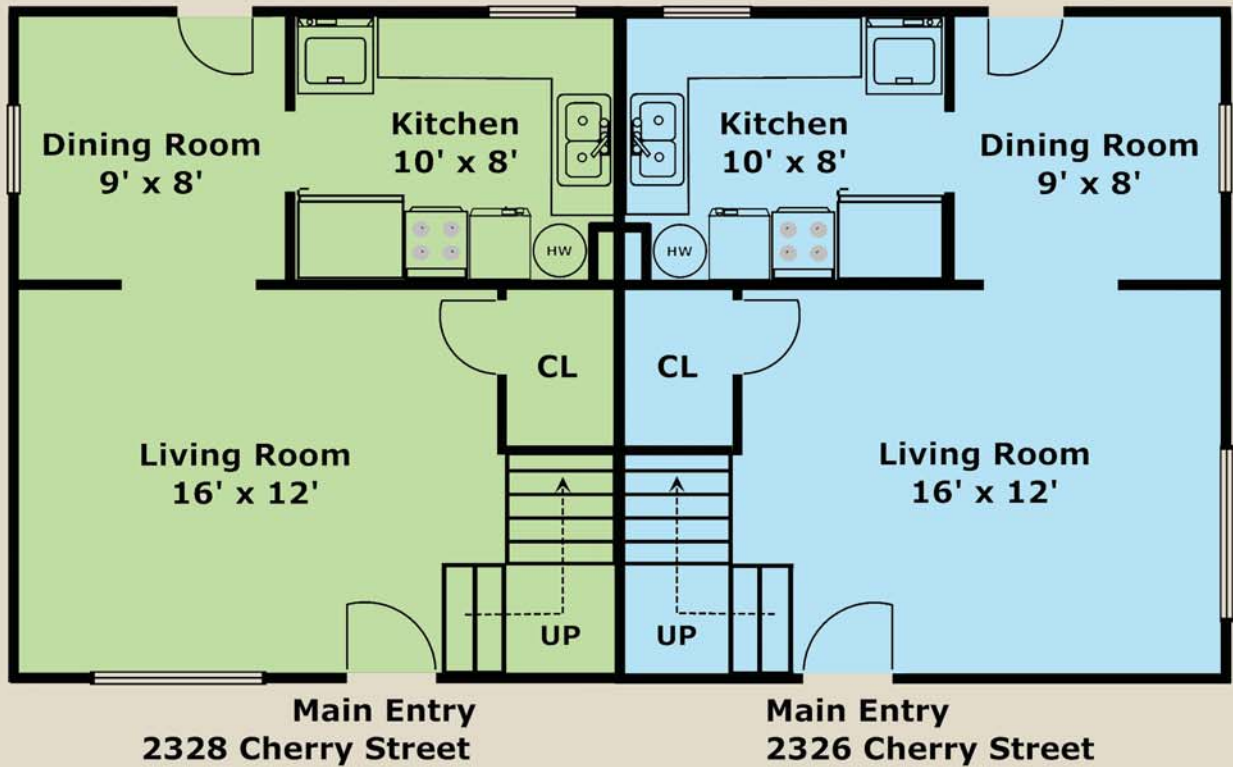

LOWER LEVEL

Layout and all measurements are approximate, and not guaranteed to be either exact or to scale.